

# WE256-COMPLETE FREESTANDING WASH BASIN UNIT

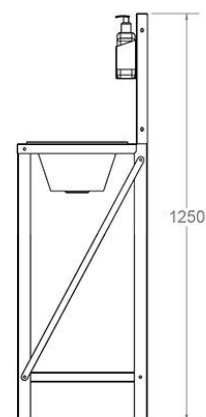
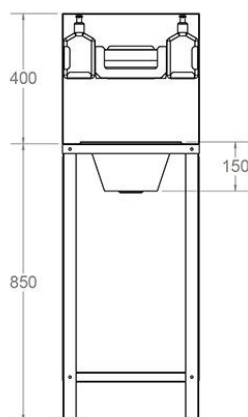
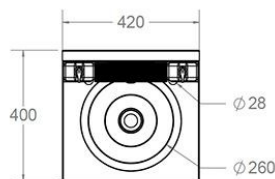

## **Description**

- Model WE256-COMPLETE is a stainless steel freestanding wash basin with support frame
- Stainless steel, 1.2mm thick
- Wash basin is mounted onto the stainless steel frame
- Drilled with one single 35mm tap hole
- The rear splashback neatly houses a soap bottle holder, sanitizer bottle holder and a paper towel dispenser making the unit fully self-contained hand washing unit
- Designed to be freestanding for areas where wall fixing is not possible
- Cost effective solution where point of use hand washing is required
- This unit has proven to be a popular solution in the coronavirus field hospitals

## **Includes**

- 32mm flush grated waste fitting
- Overflow plug and chain
- Stainless steel frame and shelf
- Rear upstand
- Two soap/sanitizer dispensers (bottles not included)
- Paper towel dispenser (towels not included)

## **Delivery**

- In stock 1-2 working days

## **Dimensions**

**Front to back:** 400mm, **Width:** 420mm, **Bowl depth:** 140mm, **Height:** 1250mm, **Bowl diameter:** 260mm

## **Optional extras**

**SMALL-PLASTIC-BOTTLETRAP** – 1.25" plastic bottle trap

**SMALL-CHROME-BOTTLETRAP** – 1.25" chrome plated brass bottle trap

**WETHB** – tap hole blank for blanking off pre-drilled holes

**LEVER SINK TAPS WITH 6 INCH LEVERS**

**TAPS FROM OUR EXTENSIVE RANGE**